

**Model :** **NEW** ABYG30LRTE / **NEW** ABYG36LRTE / **NEW** ABYG45LRTA /  
 ABYG36LRTA [3phase] / ABYG45LRTA [3phase] / ABYG54LRTA [3phase]



Wireless R.C.



For ABYG30/36LRTE



For ABYG36/45/54LRTA



## Features

### Installation

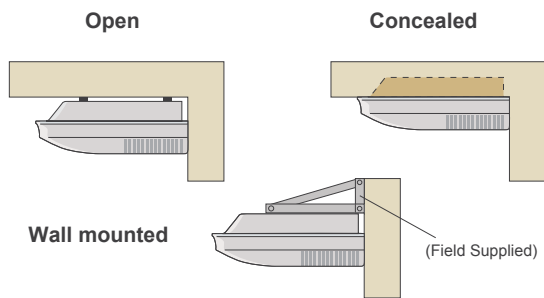

### Multi auto swing

A combination of right/left and up/down directional swing allows 3-dimensional air direction control.

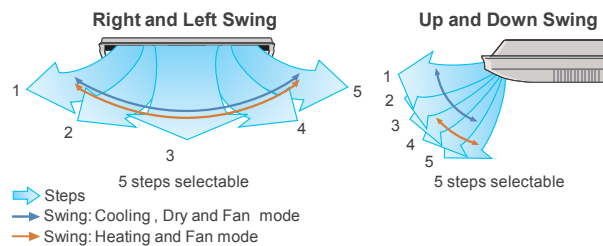

### Condensate lift-up mechanism (Option)

Optional drain lift-up mechanism allows flexible installation.

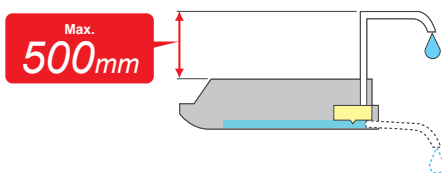

### Low ambient operation

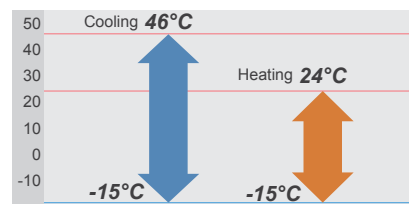

### Easy installation

Main work settings can be done easily from the remote controller at installation

#### Main work settings

- High ceiling setting
- Auto restart
- Temperature adjustment when cooling / heating

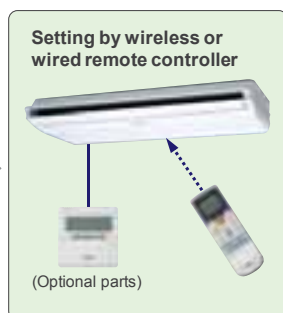
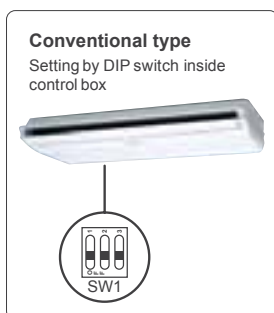

### Fresh air intake

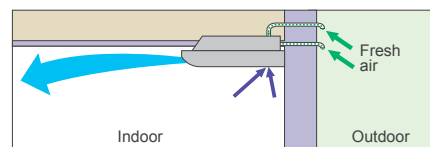

#### Optional parts

- Wired Remote Controller: UTY-RNNYM, UTY-RVNYM
- Simple Remote Controller: UTY-RSNYM
- Drain Pump Unit: UTR-DPB24T
- External Connect Kit: UTY-XWZX, UTY-XWZX22, UTY-XWZX23
- External Control Set: UTD-ECS5A
- Flange: UTD-RF204



## Specifications

Model No.	Indoor unit		ABYG30LRTE	ABYG36LRTE	ABYG45LRTA	ABYG36LRTA	ABYG45LRTA	ABYG54LRTA
	Outdoor unit		AOYG30LETL	AOYG36LETL	AOYG45LETL	AOYG36LATT	AOYG45LATT	AOYG54LATT
Power Source	V/∅/Hz		230/1/50	230/1/50	230/1/50	400/3/50	400/3/50	400/3/50
Capacity	Cooling	kW	8.5(2.8~10.0)	9.4(2.8~11.2)	12.1(4.0~13.3)	10.0(4.7~11.4)	12.5(5.0~14.0)	14.0(5.4~16.0)
	Heating		10.0(2.7~11.2)	11.2(2.7~12.7)	13.3(4.2~15.5)	11.2(5.0~14.0)	14.0(5.4~16.2)	16.0(5.8~18.0)
Input Power	Cooling/Heating	kW	2.65/2.77	2.93/3.02	3.77/3.68	2.84/2.87	3.89/3.88	4.65/4.67
EER	Cooling	W/W	3.21	3.21	3.21	3.52	3.21	3.01
COP	Heating		3.61	3.71	3.61	3.90	3.61	3.43
Pdesign	Cooling/Heating	kW	8.5/8.0	9.4/8.7	-	10.0/10.0	-	-
SEER	Cooling	W/W	6.10	6.00	-	6.10	-	-
SCOP	Heating		4.20	4.10	-	4.10	-	-
Energy Efficiency Class	Cooling	A++		A+	-	A++	-	-
	Heating	A+		A+	-	A+	-	-
Running Current	Cooling/Heating	A	11.6/12.2	12.8/13.2	16.5/16.1	4.3/4.4	5.8/5.8	6.9/6.9
Annual Energy Consumption	Cooling	kWh/a	487	548	-	573	-	-
	Heating		2662	2965	-	3414	-	-
Moisture Removal	l/h		2.5	3.0	4.0	3.0	4.5	5.0
Sound Pressure (Cooling)	Indoor	H/M/L/Q	45/43/37/32	47/43/37/32	49/45/39/34	47/43/37/32	49/45/39/34	51/48/42/38
	Outdoor		High	53	54	55	51	54
Sound Power (Cooling)	Indoor	High	57	60	-	61	-	-
	Outdoor		High	68	69	-	67	-
Airflow Rate (High)	Indoor / Outdoor	m <sup>3</sup> /h	1660/3600	1900/3800	2100/6200	1900/6200	2100/6900	2300/6900
Net Dimension H x W x D	Indoor	mm	240×1660×700	240×1660×700	240×1660×700	240×1660×700	240×1660×700	240×1660×700
		kg(lbs)	46(101)	46(101)	46(101)	46(101)	46(101)	48(106)
	Outdoor	mm	830×900×330	830×900×330	1290×900×330	1290×900×330	1290×900×330	1290×900×330
		kg(lbs)	61(135)	61(135)	86(190)	104(229)	104(229)	104(229)
Piping Connections (Small / Large)	mm		9.52/15.88	9.52/15.88	9.52/15.88	9.52/15.88	9.52/15.88	
Drain Hose Diameter (I.D./O.D.)	mm		21.5/26.0	21.5/26.0	21.5/26.0	21.5/26.0	21.5/26.0	
Max Pipe Length (Pre-Charge)	m		50(20)	50(20)	50(20)	75(30)	75(30)	75(30)
Max Height Difference	m		30	30	30	30	30	30
Operation Range	Cooling	°CDB	-15~46	-15~46	-15~46	-15~46	-15~46	-15~46
	Heating		-15~24	-15~24	-15~24	-15~24	-15~24	-15~24
Refrigerant (Global Warming Potential)			R410A(1,975)	R410A(1,975)	R410A(1,975)	R410A(1,975)	R410A(1,975)	R410A(1,975)

## Dimensions Models : AYG30LRTE / AYG36LRTE / AYG36LRTA / AYG45LRTA / AYG54LRTA

(Unit : mm)

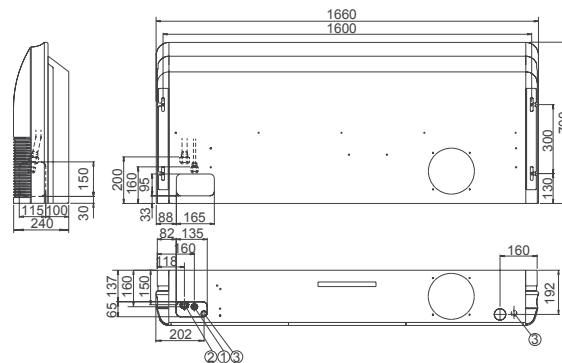

- ① Refrigerant piping flare connection (Liquid)
- ② Refrigerant piping flare connection (Gas)
- ③ Drain piping connection